

YF4A-2

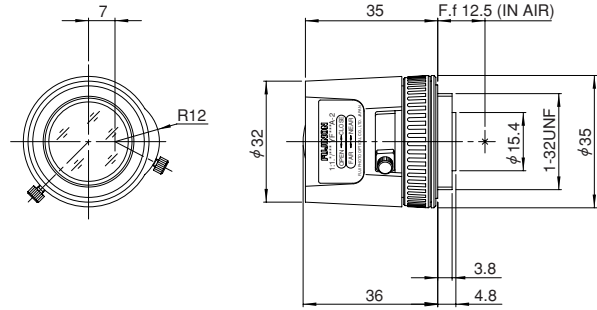

Unit : mm

Model		YF4A-2
Focal Length		4mm
Iris Range		F1.2 ~ Close
Operation	Iris	Manual
	Focus	Manual
Angle Of View (H × V)	1/3"	65°21' × 49°27'
	1/4"	49°27' × 37°15'
Focusing Range (From Front Of The Lens)		∞ ~ 0.1m
Object Dimensions at M.O.D. (H × V)	1/3"	132mm × 99mm
	1/4"	99mm × 73mm
Back Focal Distance (in air)		8.62mm
Exit Pupil Position (From Image Plane)		727mm
Filter Thread		—
Mount		CS Mount
Mass		30g
Remarks		